

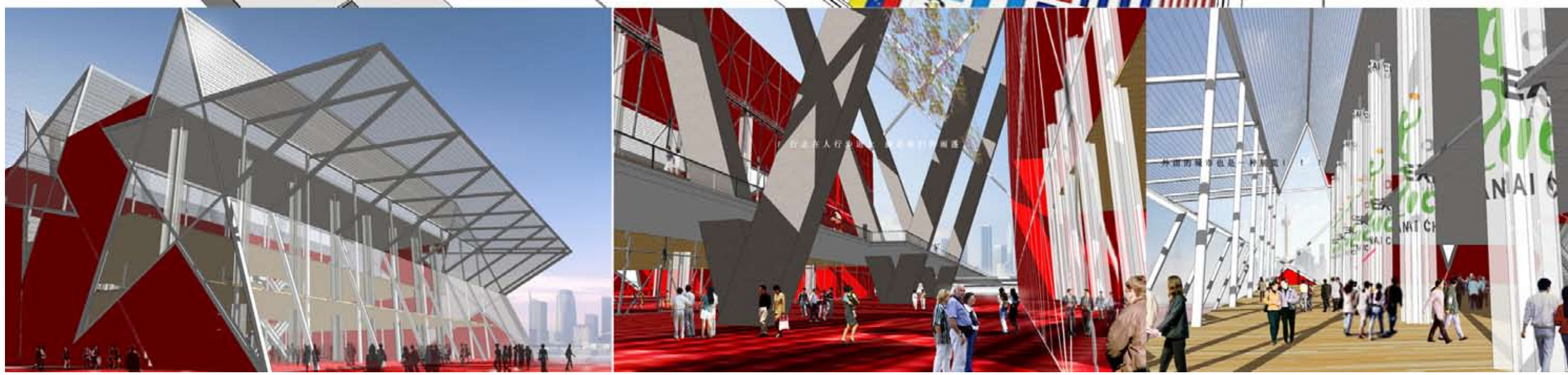

We strive for simplicity and directness in our design process in order to make our design intentions and concepts easily understood and accepted by Chinese clients and general public. While respecting clients cultural preferences, we employ simple architectural tricks such as playing with scale, repetition, everyday objects, local materials and colours in solving design issues. Instead of treating them as separate projects we think of the work as a process, an idea or a belief appropriate to local culture. All projects in China are done with extreme limitation on budget and time but we are able to maintain our playfulness and sense of humour while rushing to get them built. Apart from competition entries all work shown here are either under-construction or near completion.

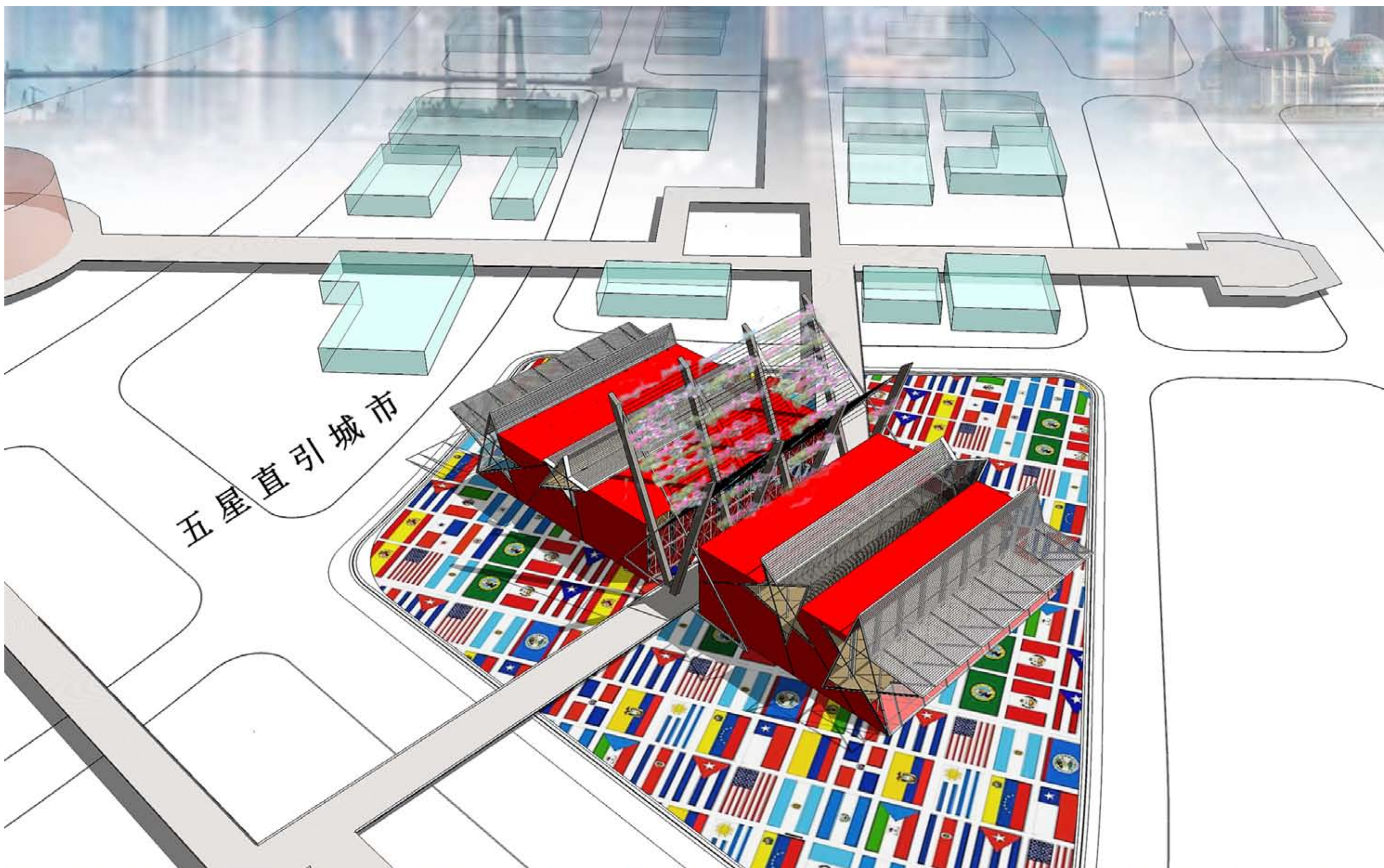

Back in 2002, friends of mine founded Hangzhou Jian Yuan Architects and Engineers in China. It was a small architectural firm consisting of draftsman and engineers doing mainly residential buildings. As many large overseas architectural firms entered China, they were struggling to compete for projects and felt the need to run the office differently by being more design-oriented. A design job opportunity was offered to me because of my 'foreign' background and RMIT Architecture degree qualification. I joined the firm as an Associate Director who was supposed to take good care of all design work for them. Now, the firm is expanding rapidly with projects ranging from urban planning and landscaping to designing a ten square metre public toilet. We attract local clients who welcome new ideas and those who want good value for their 'renminbi', due to our ability to produce inexpensive but expressive structures.

architecture 2000

henfry marvin

associate director architect

hangzhou, china

