



The design for the NRN CITY, Housing project explored the potential of high rise urban living with modern facilities and amenities under one roof. The building of both the residential and the commercial sections responded to the need of an environmentally sustainable design. The five parameters guiding the design construction were: sustainability of site and the response to the surrounding environment; water efficiency; energy and atmosphere; material and resources and indoor air quality.

The focus of the planning was on the maximization of direct sunlight and ventilation. The placement of the residential towers in a linear fashion along the northern boundary and the communal space on the south, gave the opportunity to provide each unit with southern sunlight and a scenic view of the Himalayas and the mountains in the north. The commercial building of the complex was designed to act as a filter protecting the open space of the apartment blocks from the noise and dust from a nearby major road. Trees and plants were inserted in the building envelope to improve the air quality of the commercial as well as residential spaces.

Several layers of fins were introduced in the residential towers to act as a sun shade device in the summer. A series of planting strips were introduced along these strips to create vertical landscape. The vertical landscape wall is also used to purify grey water. The horizontal and vertical design elements in the form of living walls, roof gardens and interior garden have been incorporated to not only improve the interior environment but also increase the productivity of people.

The design for the Union Finance building explores the unrealized potential of an office workspace. The main concept of the project anchors around the relationship between public open spaces, interactive spaces and individual cellular private works spaces. A series of volumes are carved out from the building envelope giving an opportunity to create potential interactive spaces. The design concentrates on utilizing these voids to channel sunlight and fresh air deep into the building. The staggered nature of the voids also enhances visual links and encourages interaction between office spaces in different floors. The semi-open outdoor/indoor voids function to create diversity in the homogeneous office space and act as relief points in an intense modern day office space.

The building skin attempts to express the nature of image of Union Finance Co. Ltd. The gradual increase in transparency of the façade depicts the progressive nature of the company and desire for transparency. The building skin is an image of a typical bar code, a symbol of modern day number society, which is gradually stretched to increase the transparency as one moves up from the ground floor. This also helps in maintaining privacy on the lower floors from the streetscape and maximize natural light on the upper floors, as well as keeping vastu sastra (a traditional Hindu system of design based on directional alignments) in mind.

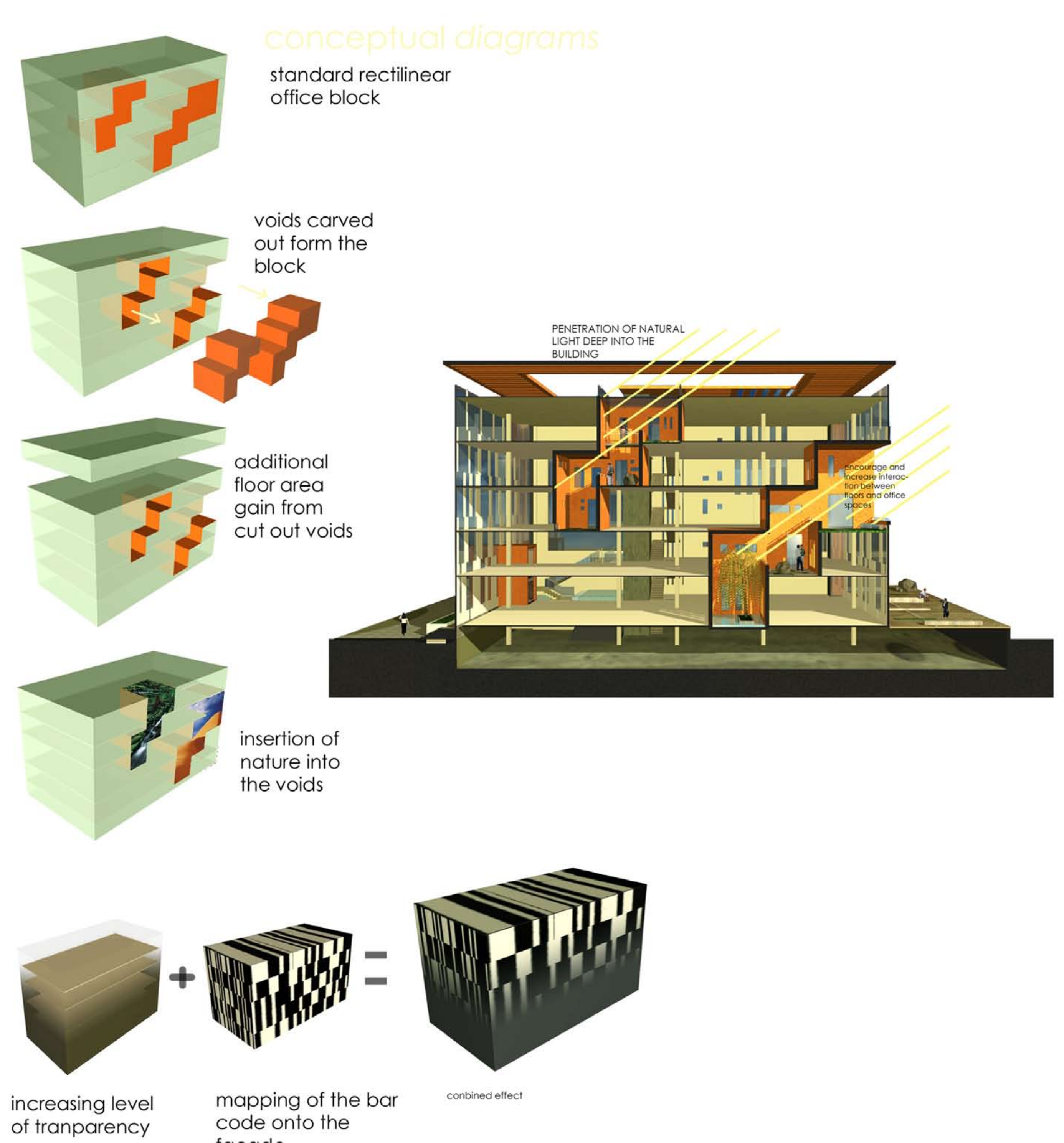
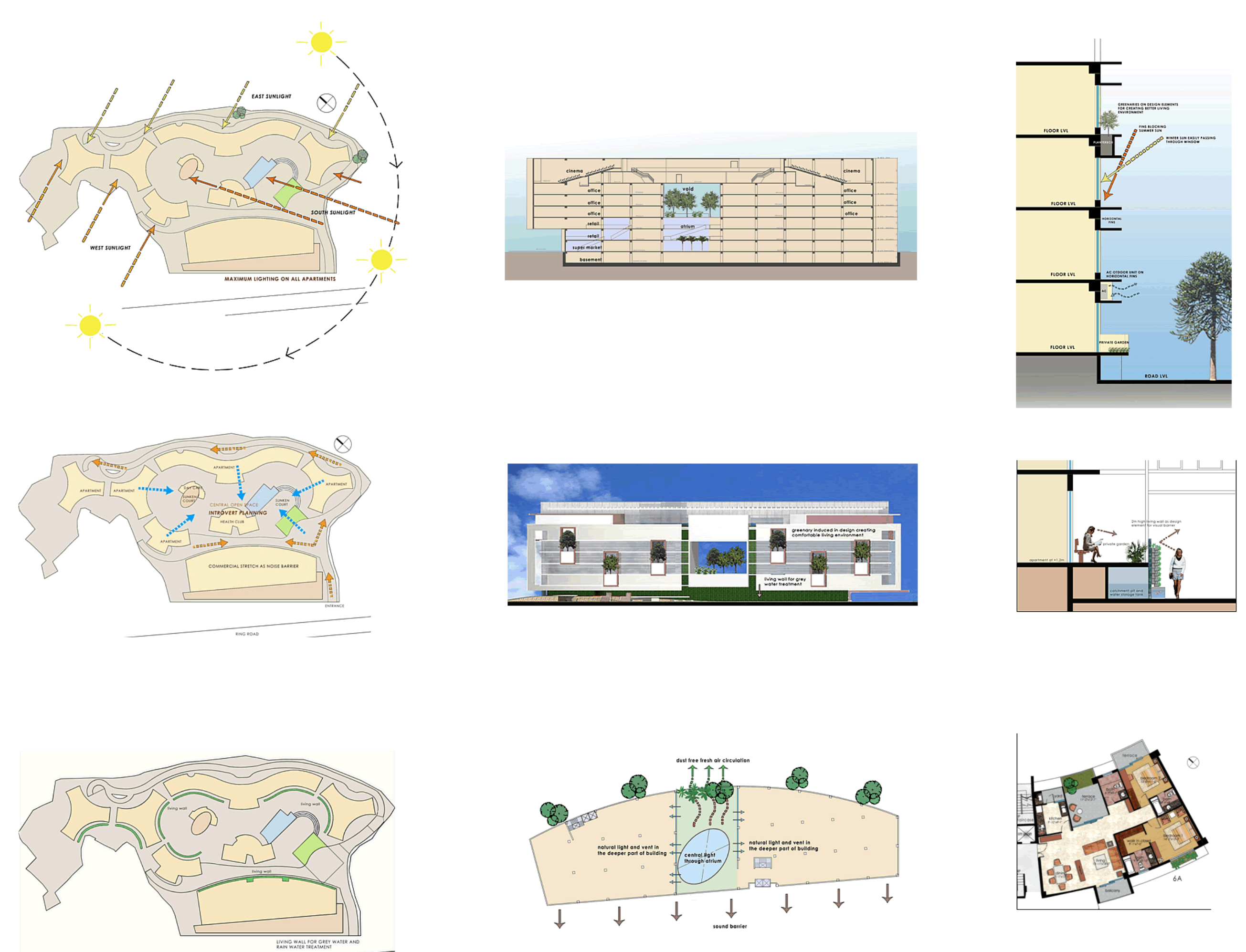

architect 1998

sanjay lal shestra

architect/ founding director

katmandu, nepal

After graduating, Sanjay worked for at William Lim Associates in Singapore for four years. He then moved back home to Katmandu Nepal and established Outré Design in November 2003. The firm concentrates on bringing out change in the rather conservative society of Nepal by introducing modern concepts both in terms of planning and architectural expression. Simplicity, transparency and clean design and a desire to incorporate sustainable design solutions distinguishes the firm's designs.

